

Appendix 32

Cotswold Road/Poplars Avenue Access Option B

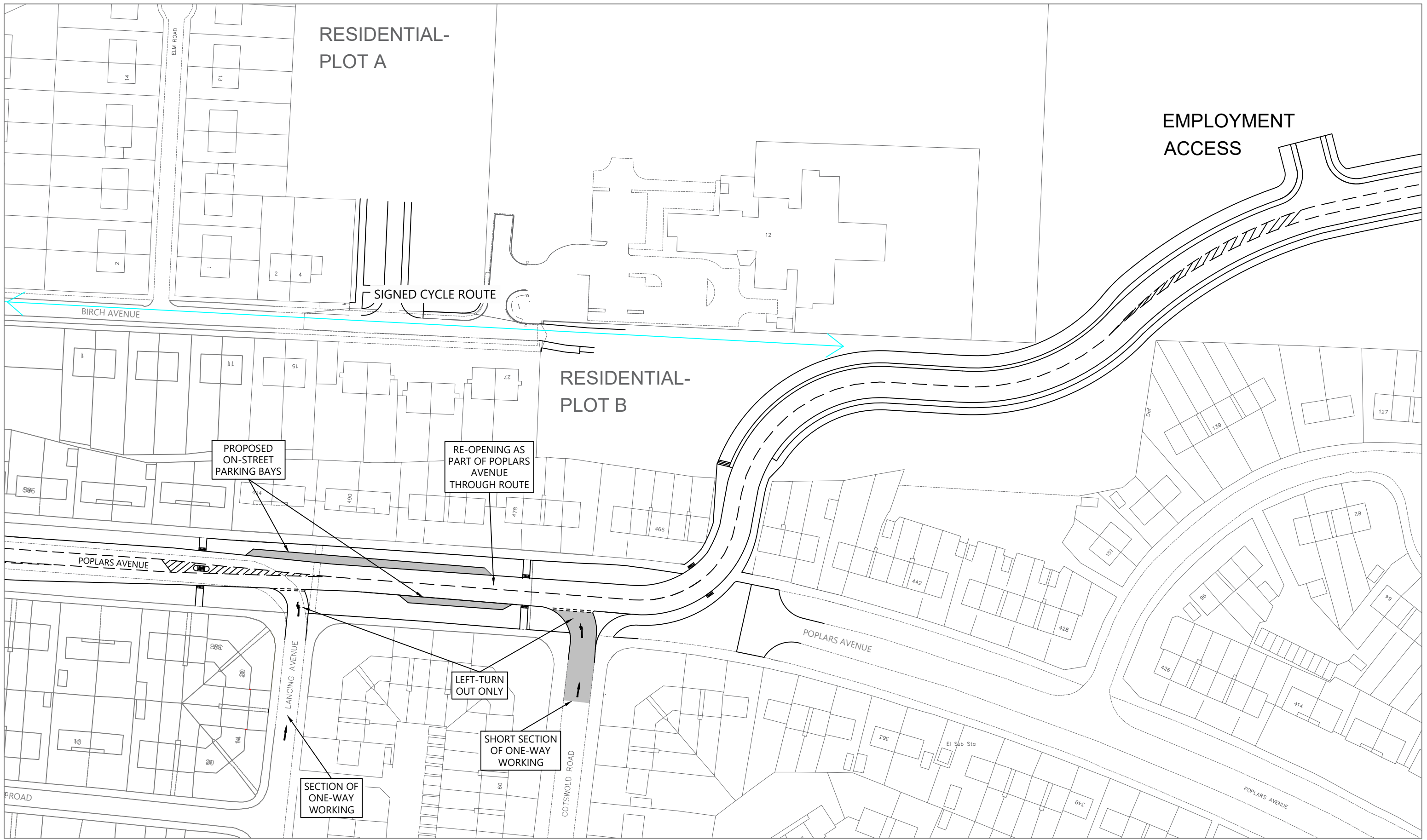

NOTES:
 © Crown Copyright 2017 OS 100056454



ISSUE	REASON FOR REVISION	DATE
DATE:	DRAWN BY:	CHECKED:
26/01/18	FB	DT

PROJECT:
PEEL HALL, WARRINGTON

CLIENT:
SATNAM MILLENNIUM LTD

TITLE:
WESTERN ACCESS AT POPLARS AVENUE - THROUGH ROUTE

PROJECT REFERENCE: 1107
 DRAWING NUMBER: 46/B
 SCALE: 1:1,000 @ A3

HighgateTransportation
www.highgatetransportation.co.uk
 First Floor, 43-45 Park Street
 Bristol BS1 5NL
 07973 375 937 / 07595 892 217
 © Highgate Transportation Limited